



**GLASS EXPANSION**

Quality By Design

# Instruction Manual for Magnifier Inspection Tool

**70-803-1923**



INS-0547

## Before you Start

Congratulations on your purchase of your new Magnifier Inspection Tool. Please check to ensure your package contains the following items:

1

Magnifier Inspection Tool



2

Hook Tool



## Turning on the LED



Hold the loupe and rotate the focus knob in counter-clockwise direction to open the battery compartment.

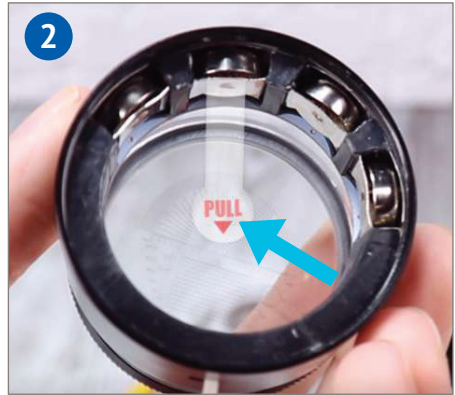

Pull the plastic film from the button batteries in the battery compartment to remove it.



Hold the loupe and close it by rotating the focus knob in a clockwise direction.



Turn on/off the LED by simply switching it on or off.

## Changing the Batteries



First, Open the battery compartment. Use the small metal tool (hook) that is included in the set to easily remove the old AG9 button batteries.



Insert four new AG9 button batteries in the battery compartment. Make sure to insert the batteries in correct polarity position. Close the loupe after.

## Changing the Scale



This meter has a detachable reticle glass scale, if you want to remove and change it just simply rotate the detachable scale on the meter.



For more information please visit [www.geicp.com](http://www.geicp.com) or contact one of our offices below.

### **International**

6 Central Boulevard, Port Melbourne,  
VIC 3207, Australia

Telephone: +61 3 9320 1111

Email: [enquiries@geicp.com](mailto:enquiries@geicp.com)

### **Americas**

31 Jonathan Bourne Drive, Unit 7  
Pocasset, MA 02559, USA

Telephone: 508 563 1800

Email: [geusa@geicp.com](mailto:geusa@geicp.com)

### **Europe**

Friedenbachstrasse 9, 35781 Weilburg,  
Germany

Telephone: +49 6471 3778517

Email: [gegmbh@geicp.com](mailto:gegmbh@geicp.com)